

INDUSTRIAS ENRIQUE  
**GALAN**

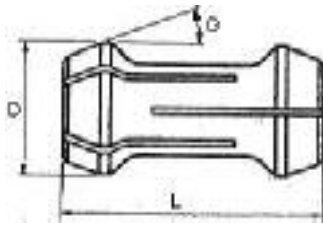

**PINZAS DE DOBLE CONO**  
**PINCES DE DOUBLE CONE**  
**DOUBLE TAPER COLLETS**  
**COPEL KONUS SPANNSANGEN**  
**PINZA DOPPIO CONO**

MARCA TORNO	MODELO	d	D	G°	EINHEITS	Referencia Galán
<i>MACHINE</i>	<i>MODEL</i>					<i>Galan code</i>

<b>BECHET</b>	RM 10	17	54	17,3	8529 E	<b>G-410-F2C</b>
	RM 3268	43	68	20		<b>G-47-F2C</b>
	RM 1055	22	50	25	8578 E	<b>G-455-F2C</b>
	RM 15	25,5	50	14	8639 E	<b>G-415-F2C</b>
	RM 19	31	55	14	8686 E	<b>G-419-F2C</b>
	RM 25	40	75	20	8789 E	<b>G-425-F2C</b>
	RM/TCN 32	43	68	14	8810 E	<b>G-432-F2C</b>
<b>BECHLER</b>	B/BR-20	32	68	14,3	8689 E	<b>G-420-F2C</b>
<b>BODEM</b>	46	60	80	17	8003 EC	<b>G-2760-F</b>
<b>BOLEY</b>	RD25-4HR-SR26	35	85	17,3	869 E	<b>G-4126-F2C</b>
<b>BIGLIA</b>	110-130-131 45	60	80	17	8003 EC	<b>G-2760-F</b>
	110-130-131 56	71,6	100	18		<b>G-2770-F</b>
	110-130-131 70	90	100	100		<b>G-2790-F</b>
<b>CABALLERIA</b>	TR-30	43,6	83	20		<b>G-2730-F</b>
	TR-35	48	90	20		<b>G-2735-F</b>
	TR-40	53	90	20		<b>G-2740-F</b>
<b>CANMA</b>	TA-30	43,6	83	20		<b>G-2730-F</b>
	TA-42	53	90	20		<b>G-2740-F</b>
<b>CASER</b>	TA-26	34	55	17,3	8001 EC	<b>G-4126-F2C</b>
	TA-30	42	82	17		<b>G-1524-F2C</b>
	TA-46	60	80	17		<b>G-1746-F2C</b>
	TA-50	70	80	16		<b>G-2952-F2C</b>
<b>DANOBAT</b>	Danocopy-42	58	90	20		<b>G-1145-F</b>
	Danomatic-51	68	115	18		<b>G-1150-F</b>
	Danocopy-51	68	115	18		<b>G-1150-F</b>
	Imematic 50/60	78	130	18		<b>G-1160-F</b>
	Danomatic-63	88	130	18		<b>G-1170-F</b>
	Danocopy-63	88	130	18		<b>G-1170-F</b>
<b>IRALAG</b>	TA-25	38	83	20		<b>G-2725-F</b>
	TA-30	43,6	83	20		<b>G-2730-F</b>
	TA-35	48	90	20		<b>G-2735-F</b>
	TA-40	53	90	20		<b>G-2740-F</b>
	TA-45	58	90	20		<b>G-1145-F</b>
	TA-50	68	115	18		<b>G-1150-F</b>
	TA-60	78	130	18		<b>G-1160-F</b>
	TA-70	84	130	18		<b>G-1170-F</b>
	TA-95	112	130	18		<b>G-1195-F</b>
<b>JATOR</b>	J-30-165	42	86	20		<b>G-2630-F</b>
	J-35-175	50	86	20		<b>G-2635-F</b>
	J-40-180	53	90	20		<b>G-2740-F</b>
	J-50-180	62	90	20		<b>G-2650-F</b>

INDUSTRIAS ENRIQUE  
**GALAN**

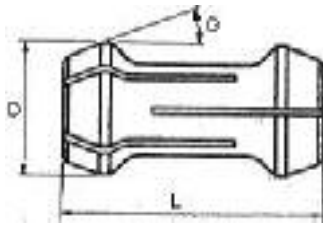

**PINZAS DE DOBLE CONO**  
**PINCES DE DOUBLE CONE**  
**DOUBLE TAPER COLLETS**  
**COPEL KONUS SPANNSANGEN**  
**PINZA DOPPIO CONO**

MARCA TORNO	MODELO	d	D	G°	EINHEITS	Referencia Galán
<i>MACHINE</i>	<i>MODEL</i>					<i>Galan code</i>
<b>MANURHIN</b>	TR-16 B	25	60	25	8617 E	<b>G-1716-F2C</b>
	PF/TR-22	32	70	20	8692 E	<b>G-1722-F2C</b>
	KMX 26	40	75	20	8789 E	<b>G-1725-F2C</b>
	PF/TR-32	50	100	20	8848 E	<b>G-1732-F2C</b>
	PF/TR-42	59	120	20	8890 E	<b>G-1742-F2C</b>
	Combimat 42	59	120	20	8890 E	<b>G-1742-F2C</b>
	Decomat 42	59	120	20	8890 E	<b>G-1742-F2C</b>
	MAX 60	78	130	18	8923 E	<b>G-1760-F2C</b>
	Decomat 60	78	130	18	8923 E	<b>G-1760-F2C</b>
	MAX 65	83	130	18	8925 E	<b>G-1765-F2C</b>
<b>SAIC</b>	B-26	34	55	17,3	8001 EC	<b>G-2726-F</b>
	B-26	34,5	74	25	8002 EC	<b>G-2726-F2</b>
	A-30	40,5	75	25		<b>G-2730-F</b>
	B-45	60	60	17	8003 EC	<b>G-2760-F</b>
<b>STROHM TARATTE</b>	M105/125	19	55	25		<b>G-3510-F2C</b>
	B-0	17	45,5	22,3	8531 E	<b>G-520-F2C</b>
	B-12	22	56	22,5	8580 E	<b>G-5212-F2C</b>
	B-16	31	72,5	20	8675 E	<b>G-5216-F2C</b>
<b>TEIXIDO TORNOS</b>	A-14	22	50	18		<b>G-3914-F2C</b>
	M-10	17	36	20	8533 E	<b>G-3510-F2C</b>
	R-10	19	36	20	8545 E	<b>G-3511-F2C</b>
	B-2/M-15/M-16	25,5	50	14	8639 E	<b>G-3515-F2C</b>
	M/R/PR-20	31	24	14	8686 E	<b>G-3520-F2C</b>
	M-25	35	60	15	8731 E	<b>G-3525-F2C</b>
	M-30	43	68	14	8810 E	<b>G-3530-F2C</b>
<b>TRAUB</b>	A/TC-25	35	84	20		<b>G-4125-F2C</b>
	A/TB-25	35,5	74	25		<b>G-4126-F2C</b>
	TD-26	35,5	74	25		<b>G-4126-F2C</b>
	TB-30	42	82	17		<b>G-4130-F2C</b>
	TNL 32	42	50	22,3		<b>G-4132-F2C</b>
	A/TB-42	53	90	20		<b>G-2740-F</b>
	A-45	60	80	17		<b>G-4145-F2C</b>
	A/TB-60	71,6	100	18		<b>G-2960-F2C</b>
<b>UNAMUNO</b>	A-15	22	50	18		<b>G-3914-F2C</b>
	A-25	35	84	20		<b>G-4125-F2C</b>