

CAÑONES GUÍA

Guide Bushes

En acero y con pastilla de metal duro para tornos automáticos
Steel and carbide for automatic lathes



BECHLER
GAUTHIER
PETERMAN

STROHM
TEIXIDO
TORNOS

INDUSTRIAS ENRIQUE

GALAN

S.A.

www.iegalan.com

iegalan@iegalan.com

* [PINZAS](#)
* [HERRAMIENTAS](#)
* [METROLOGÍA](#)
* [AUTOMATIZACIÓN](#)

MADRAZO, 4 - 08006
BARCELONA - ESPAÑA

Tel: +34 932 174 808 - Fax.: +34 932 178 555

INDUSTRIAS ENRIQUE
GALAN

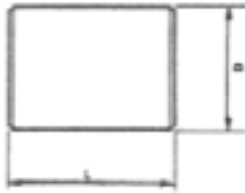

CAÑONES METAL DURO TIPO 1
CANON METAL DUR TYPE 1
GUIDE BUSHING HM TYPE 1
FUHRUNGSBUCHSE HM TIPE 1
BUSSOLE GUIDA M.D. TIPO 1

MARCA TORNO	MODELO	D	L	Referencia Galán
<i>MACHINE</i>	<i>MODEL</i>			<i>Galan code</i>

GAUTHIER	GM-75/127	12	20	G-43.13-CFMD12-1
	GM-75/127	20	26	G-43.13-CFMD20-1
	GM-25	25	35	G-43.13-CFMD25-1
	GM-25	30	35	G-43.13-CFMD30-1
	GM-25	35	35	G-43.13-CFMD35-1
STROHM	M-45	10	18,0	G-36.5-CFMD10-1
	M-75/105/125	15	30,0	G-36.13-CFMD15-1
	M-75/105/125	20	30	G-43.13-CFMD20-1
	M-205/255	15	30	G-36.13-CFMD15-1
	M-205/255	20	30	G-36.13-CFMD20-1
	M-205/255	32	45	G-36.13-CFMD32-1
	M-205/255	36	45	G-36.13-CFMD36-1

INDUSTRIAS ENRIQUE

GALAN

S.A.

www.iegalan.com

iegalan@iegalan.com

* [PINZAS](#)
* [HERRAMIENTAS](#)
* [METROLOGÍA](#)
* [AUTOMATIZACIÓN](#)

MADRAZO, 4 - 08006
BARCELONA - ESPAÑA

Telf: +34 932 174 808 - Fax.: +34 932 178 555

INDUSTRIAS ENRIQUE
GALAN

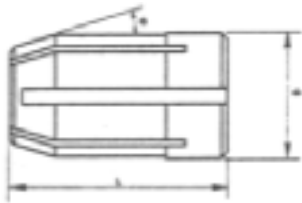

CAÑONES METAL DURO TIPO 2
CANON METAL DUR TIPE 2
GUIDE BUSHING HM TYPE 2
FUHRUNGSBUCHSE HM TIPE 2
BUSSOLE GUIDA M.D. TIPO 2

MARCA TORNO	MODELO	D	L	G°	Referencia Galán
<i>MACHINE</i>	<i>MODEL</i>				<i>Galan code</i>

BECHLER	A-7/A-10	40	40	30	G-4.10-CFMD-2
	A-10	40	40	30	G-4.10-CFMD20-2
	B/BR/Be 12-16-20	60	60	29	G-4.16-CFMD-2
	B/BR 12-16-20	60	60	29	G-4.20-CFMD-2
	Be reforzado	60	60	29	G-4.20-CFMD-2
	C-26	72	72	29	G-4.26-CFMD-2
STROHM	C/CR-26-32	72	72	29	G-4.32-CFMD-2
	M-45	9	30	19	G-35.4-CFMD-2
	M-75/105/125	15	35	19	G-36.10-CFMD-2
	M-205	28	45	29	G-35.20-CFMD-2
TEIXIDO TAMAROGA TORNOS	M-205/255	32	45	19	G-35.25-CFMD-2
	A-14	24	42	19	G-33.16-CFMD-2
	TAM-16	24	42	19	G-33.16-CFMD-2
	M-4/T-4	9	30	19	G-35.4-CFMD-2
	M-75/105/125	11	30	19	G-35.7-CFMD-2
	M-10/R-10	16	35	19	G-35.10-CFMD-2
	M-15/R-16	24	42	19	G-33.16-CFMD-2
	R-20/M-20/RR-20	28	45	29	G-35.20-CFMD-2
M-20/M-25	32	45	19	G-35.25-CFMD-2	

INDUSTRIAS ENRIQUE

GALAN

S.A.

www.iegalan.com

iegalan@iegalan.com

* [PINZAS](#)
* [HERRAMIENTAS](#)
* [METROLOGÍA](#)
* [AUTOMATIZACIÓN](#)

MADRAZO, 4 - 08006
BARCELONA - ESPAÑA

Tel: +34 932 174 808 - Fax.: +34 932 178 555

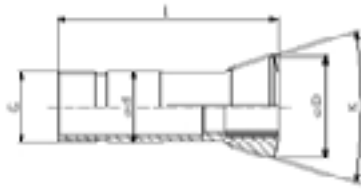

CAÑONES METAL DURO TIPO 3
CANON METAL DUR TYPE 3
GUIDE BUSHING HM TYPE 3
FUHRUNGSBUCHSE HM TIPO 3
BUSSOLE GUIDA M.D. TIPO 3

MARCA TORNO	MODELO	d	D	L	G°	ROSCA	Referencia Galán
<i>MACHINE</i>	<i>MODEL</i>					<i>THREAD</i>	<i>Galan code</i>

CITIZEN	G/D 10	16	20	59	16	14x1	G-35.10-CFMD-3
	D 10	18	22	60	30	16x1	G-36.13-CFMD-3
	F/G/L/E 16	24	30	61	30	24x1	G-35.16-CFMD-3
	Serie R04	9	12,5	44	16	8x0,75	G-35.4-CFMD-3
	Serie B12	18	22	60	30	16x1	G-36.13-CFMD-3
	Serie B20	28	38	81	16	25x1	G-B261-CFMD-3
	Serie C16	24	30	61	30	24x1	G-35.16-CFMD-3
	Serie M12	18	22	60	30	16x1	G-36.13-CFMD-3
	Serie M16	24	30	61	30	24x1	G-35.16-CFMD-3
	Serie M20	28	38	81	16	25x1	G-B261-CFMD-3
	Serie M32	42		81	16	40x1	G-J9-CFMD-3
	Serie L10	16	20	58	16	14x1	G-35.10-CFMD-3
	Serie L10w	9	12,5	44	16	8x0,75	G-35.4-CFMD-3
	Serie L16	24	30	61	30	24x1	G-35.16-CFMD-3
	Serie L20	28	38	81	16	25x1	G-B261-CFMD-3
	Serie L25	34	41	87	10	34x1	G-1726-CFMD-3
	Serie L32	42		81	16	40x1	G-J9-CFMD-3
	Serie E16	24	30	61	30	24x1	G-35.16-CFMD-3
	Serie E20	32		71	30	32x1	G-B214-CFMD-3
	Serie E25	34	41	87	10	34x1	G-1726-CFMD-3
	Serie E32	42		81	16	40x1	G-J9-CFMD-3
	Serie F12	18	22	60	30	16x1	G-36.13-CFMD-3
	Serie F16	24	30	61	30	24x1	G-35.16-CFMD-3
	Serie F20	32		71	30	32x1	G-B214-CFMD-3
	Serie F25	34	41	87	10	34x1	G-1726-CFMD-3
GAUTHIER MANURHIN	GM-25	40	48	72	30	40x1	G-53.25-CFMD-3
	Traminer 13	18	22	60	30	16x1	G-36.13-CFMD-3
	Traminer 16	22	29	68	16	19x1	G-35.15-CFMD-3
	KMX 20	22	29	68	16	19x1	G-35.15-CFMD-3
	KMX 20	28	38	81	30	25x1	G-35.25-CFMD-3
	Traminer 20	22	29	68	16	19x1	G-35.15-CFMD-3
	Traminer 20	28	38	81	30	25x1	G-35.25-CFMD-3
	KMX 26	22	29	68	16	19x1	G-35.15-CFMD-3
	KMX 26	28	38	81	30	25x1	G-35.25-CFMD-3
	KMX 26	34	41	87,5	10	34x1	G-17.26-CFMD3
	Mirabel PM 32	22	29	68	16	19x1	G-35.15-CFMD-3
	Mirabel PM 32	28	38	81	30	25x1	G-35.25-CFMD-3

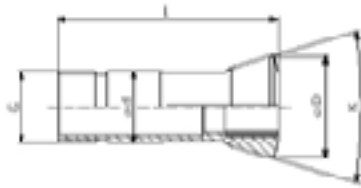

CAÑONES METAL DURO TIPO 3
CANON METAL DUR TYPE 3
GUIDE BUSHING HM TYPE 3
FUHRUNGSBUCHSE HM TIPO 3
BUSSOLE GUIDA M.D. TIPO 3

MARCA TORNO	MODELO	d	D	L	G°	ROSCA	Referencia Galán
<i>MACHINE</i>	<i>MODEL</i>					<i>THREAD</i>	<i>Galan code</i>

PETERMAN	O-P-3	7	9,5	30	16	6x0,5	G-53.3-CFMD-3
	P-4	9	11,5	25,5	30	6x0,5	G-53.4-CFMD-3
	P-7/P-7R	12	15,6	53,5	16	10x0,75	G-53.7-CFMD-3
	P-7R/10/10HS	16	20	58	16	14x1	G-35.10-CFMD-3
	10R/10HSR/2A	22	29	68	16	19x1	G-35.15-CFMD-3
	P-16/P-16R	28	38	81	30	25x1	G-35.25-CFMD-3
	P-16	24	30	61	30	24x1	G-35.16-CFMD-3
	P-25	40	48	72	30	40x1	G-53.25-CFMD-3
STAR	JNC/SNC 10	16	20	58	16	14x1	G-35.10-CFMD-3
	RNC 16	22	29	68	16	19x1	G-35.15-CFMD-3
	JNC 16/SNC 15	22	29	68	16	19x1	G-35.15-CFMD-3
	KJR 16	22	29	68	16	19x1	G-35.15-CFMD-3
	SNC 25DX	34	41	87,5	10	34x1	G-17.26-CFMD-3
	ECAS 12	22	29	68	16	19x1	G-35.15-CFMD-3
	ECAS 20	28	38	81	16	25x1	G-B261-CFMD-3
	ECAS 32T	42		81	16	40x1	G-J9-CFMD-3
	SA 12/16/RC	22	29	68	16	19x1	G-35.15-CFMD-3
	SB/SE/SI 16	22	29	68	16	19x1	G-35.15-CFMD-3
	SI 12NP	22	29	68	16	19x1	G-35.15-CFMD-3
	SH 7	16	20	58	16	14x1	G-35.10-CFMD-3
	SH-12/16	21		57	12	18x1	G-B301-CFMD-3
	SR 16/16R	22	29	68	16	19x1	G-35.15-CFMD-3
	SR 20/20R	28	38	81	16	25x1	G-B261-CFMD-3
	SR 32	42		81	16	40x1	G-J9-CFMD-3
	SV 12	22	29	68	16	19x1	G-35.15-CFMD-3
SV 20	28	38	81	16	25x1	G-B261-CFMD-3	
SV 32/32J	42		81	16	40x1	G-J9-CFMD-3	
SW 7	11	14,5	53	16	10x0,75	G-35.7-CFMD-3	
SW 7R	16	20	58	16	14x1	G-35.10-CFMD-3	
STROHM	M-45	7	9,5	30	16	6x0,5	G-53.3-CFMD-3
	M-75/105	11	14,5	53	16	10x0,75	G-35.7-CFMD-3
	M-75/105/125	18	22	60	30	16x1	G-36.13-CFMD-3
	M-105/125	16	20	58	16	14x1	G-35.10-CFMD-3
	M-205/225	22	29	68	16	19x1	G-35.15-CFMD-3
	M-205/225	40	48	72	30	36x1	G-36.25-CFMD-3
TEIXIDO	A-25	40	48	72	30	40x1	G-53.25-CFMD-3

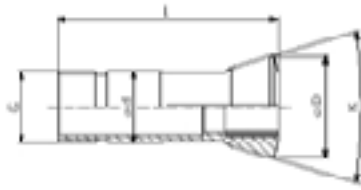

CAÑONES METAL DURO TIPO 3
CANON METAL DUR TYPE 3
GUIDE BUSHING HM TYPE 3
FUHRUNGSBUCHSE HM TIPO 3
BUSSOLE GUIDA M.D. TIPO 3

MARCA TORNO	MODELO	d	D	L	G°	ROSCA	Referencia Galán
<i>MACHINE</i>	<i>MODEL</i>					<i>THREAD</i>	<i>Galan code</i>

TORNOS	MODELO	d	D	L	G°	ROSCA	Referencia Galán
	M-4	9	12,5	44	16	8x0,5	G-35.4-CFMD-3
	M-7	11	14,5	53	16	10x0,75	G-35.7-CFMD-3
	M-7R	12	15	52	30	12x1	G-35.8-CFMD-3
	M-10/R-10	16	20	59	16	14x1	G-35.10-CFMD-3
	M-15/R-16/RR-20	22	29	68	16	19x1	G-35.15-CFMD-3
	M-20/25-28	28	38	81	30	25x1	G-35.25-CFMD-3
TORNOS-BECHLER	* TOP100	18		100	20	18x1	G-M1074-CFMD-3
	0 TOP100	16	20	59	16	14x1	G-35.10-CFMD-3
	0 TOP100	22	29	68	16	19x1	G-35.15-CFMD-3
	* ENC16	24	30	61	30	24x1	G-35.16-CFMD-3
	0 ENC16	16	20	59	16	14x1	G-35.10-CFMD-3
	* ENC74	16	20	59	16	14x1	G-35.10-CFMD-3
	* ENC162-164	24	30	61	30	24x1	G-35.16-CFMD-3
	0 ENC162-164	16	20	59	16	14x1	G-35.10-CFMD-3
	* ENC167	24	30	61	30	24x1	G-35.16-CFMD-3
	0 ENC167	16	20	59	16	14x1	G-35.10-CFMD-3
	* ENC262-264	34	42	150	20	32x1,50	G-MAGIC-CFMD-3
	* TOP200	34	42	150	20	32x1,50	G-MAGIC-CFMD-3
	* DECO7	11	14,5	53	16	10x0,75	G-35.7-CFMD-3
	0 DECO10	16	20	59	16	14x1	G-35.10-CFMD-3
	* DECO10	16	20	59	16	14x1	G-35.10-CFMD-3
	0 DECO13	24	30	61	30	24x1	G-35.16-CFMD-3
	0 DECO13	24	30	61	30	24x1	G-35.16-CFMD-3
	0 DECO13	24	30	61	30	24x1	G-35.16-CFMD-3
	* DECO13	24	30	61	30	24x1	G-35.16-CFMD-3
	0 DECO20	28	38	81	30	25x1	G-35.25-CFMD-3
	* DECO20	28	38	81	30	25x1	G-35.25-CFMD-3
	0 DECO20	34	41	87.5	10	34x1	G-1726-CFMD-3
	0 DECO26	34	41	87.5	10	34x1	G-1726-CFMD-3
	0 DECO26	34	41	87.5	10	34x1	G-1726-CFMD-3
	* DECO26	42		81	16	40x1	G-J9-CFMD-3

*	Equipo standard (la camisa porta-pinzas viene con la máquina)
0	Equipo especial (la camisa porta-pinzas se debe comprar aparte)

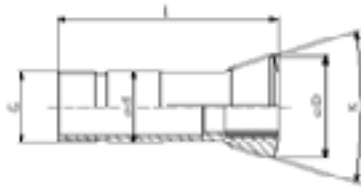

CAÑONES METAL DURO TIPO 3
CANON METAL DUR TYPE 3
GUIDE BUSHING HM TYPE 3
FUHRUNGSBUCHSE HM TIPO 3
BUSSOLE GUIDA M.D. TIPO 3

MARCA TORNO	MODELO	d	D	L	G°	ROSCA	Referencia Galán
<i>MACHINE</i>	<i>MODEL</i>					<i>THREAD</i>	<i>Galan code</i>

TSUGAMI	MODELO	d	D	L	G°	ROSCA	Referencia Galán
	BN 20	28	38	81	30	25x1	G-3525-CFMD-3
	BO 07	11	14,5	53	16	10x0,75	G-35.7-CFMD-3
	BO 12	24	30	61	30	24x1	G-35.16-CFMD-3
	BO 18	24	30	61	30	24x1	G-35.16-CFMD-3
	BU 26	34	41	87,5	10	34x1	G-1726-CFMD-3
	BS 12	24	30	61	30	24x1	G-35.16-CFMD-3
	BS 18	24	30	61	30	24x1	G-35.16-CFMD-3
	BS 20	28	38	81	30	25x1	G-35.25-CFMD-3
	BS 26	34	41	87,5	10	34x1	G-1726-CFMD-3
	BS 32	41		54	10	38x1	G-B232-CFMD-3
	BU/MU 26	34	41	87,5	10	34x1	G-1726-CFMD-3
	BU/MU 38	48		81	10	46x1	G-B240-CFMD-3
	BW 07	11	14,5	53	16	10x0,75	G-35.7-CFMD-3
	BW 12	24	30	61	30	24x1	G-35.16-CFMD-3
	BW 20	28	38	81	30	25x1	G-35.25-CFMD-3
	NB 12	24	30	61	30	24x1	G-35.16-CFMD-3

Modelos antiguos

TSUGAMI	MODELO	d	D	L	G°	ROSCA	Referencia Galán
	NP-4W	11	14,5	53	16	10x0,75	G-35.7-CFMD-3
	NT-NP 11	18	22	60	30	16x1	G-36.13-CFMD-3
	NT-NP 16	22	29	68	16	19x1	G-35.15-CFMD-3
	NT-NP 16-II	24	30	61	30	24x1	G-35.16-CFMD-3
	NT-NP 16-II	22	29	68	16	19x1	G-35.15-CFMD-3
	NT-NP 17	24	30	61	30	24x1	G-35.16-CFMD-3
	NT-NP 17	22	29	68	16	19x1	G-35.15-CFMD-3
	NT-NP 20	32		71	30	32x1	G-B214-CFMD-3
	NT-NP 20-II	28	38	81	30	25x1	G-35.25-CFMD-3
	NT-NP 32	42		81	16	40x1	G-J9-CFMD-3
	NT-NP 32-II	42		81	16	40x1	G-J9-CFMD-3
	S20	28	38	81	30	25x1	G-35.25-CFMD-3

PORTA LUNETAS GIRATORIO

Revolving guide bush holder

Con pista de metal duro

With Carbide inserts

Para tornos automáticos de cabezal móvil

For automatic lathes slide head



BECHLER

GAUTHIER

PETERMAN

STROHM

TEIXIDO

TORNOS

INDUSTRIAS ENRIQUE

GALAN

S.A.

www.iegalan.com

iegalan@iegalan.com

* [PINZAS](#)
* [HERRAMIENTAS](#)
* [METROLOGÍA](#)
* [AUTOMATIZACIÓN](#)

MADRAZO, 4 - 08006
BARCELONA - ESPAÑA

Tel: +34 932 174 808 - Fax.: +34 932 178 555